

MANUAL RELEASE MECHANISM

Note: The 760 CBAC provides a Manual Release for manually operating the gate. Although the 760 SB comes with this release mechanism, it is not necessary to use this feature to release the gate. The SB has no internal locking and can be pushed manually at any time.

The Manual Release mechanism on the Standard models is a release device of the 760 Operator (see Figure 6). This device is accessible from both sides of the gate. You disengage the hydraulic operation of the operator by opening the access door (there is one on either side of the manual release housing), inserting the triangular key, and turning the key toward the gate post one full turn. Then you can move the gate slowly by hand to open or close the gate. Operating the gate by hand is necessary during installation and is useful during power failures.

To re-engage the hydraulic operation of the gate, turn the key away from the gate post until resistance is met.

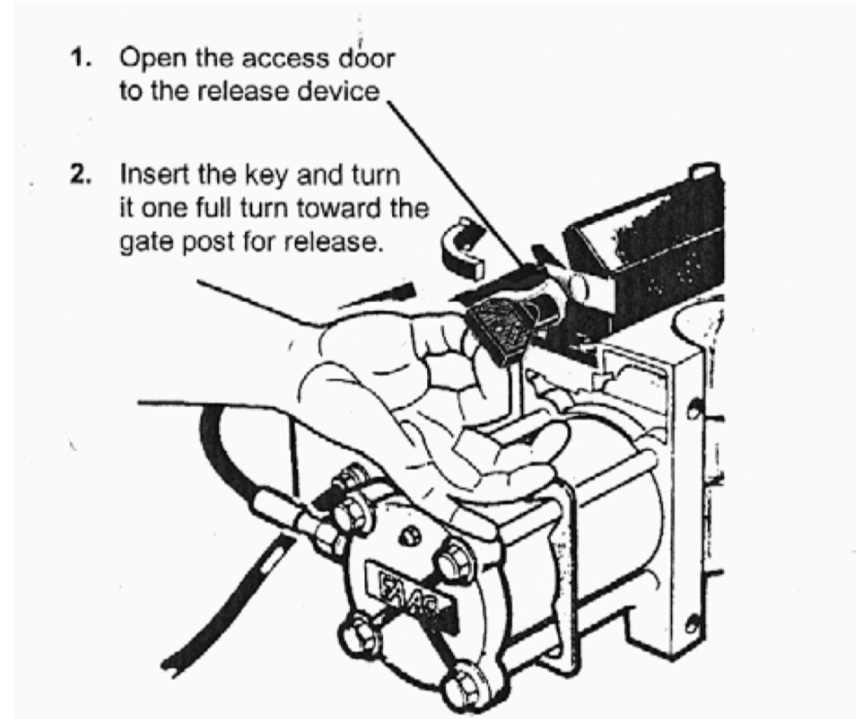

Figure 6. The Manual Release in the 760 Standard Operator